

2021 Application for Transportation Alternatives Program (TAP) projects

For:

**Section 12 Sidewalk Improvement
From West 8th Avenue to West 12th Ave and
From West 32nd St to West 37th St
HIALEAH, FLORIDA**

Presented To:

Miami-Dade MPO

Presented by:

City of Hialeah

February 2021

FLORIDA DEPARTMENT OF TRANSPORTATION DISTRICT VI
TRANSPORTATION ALTERNATIVES
APPLICATION FOR FISCAL YEAR 2026/2027
2021 Application Cycle

A. APPLICANT INFORMATION

AGENCY (Local Agency PROJECT SPONSOR): City of Hialeah	
APPLICATION CONTACT PERSON: Jose Sanchez	TITLE: Street Director
ADDRESS: 5601 E 8th Ave	CITY / STATE / ZIP: Hialeah, FL 33013
PHONE: 305-687-2696	EMAIL: JOSANCHEZ@hialeahfl.gov
PROJECT SPONSOR'S LOCAL AGENCY PROGRAM (LAP) CERTIFICATION STATUS ¹ <small>Select one response</small>	
<input type="checkbox"/> Full Certification: <i>Click here to enter text.</i> Responsible Charge: <i>Click here to enter text.</i> Phone: <i>Click here to enter text.</i>	
<input checked="" type="checkbox"/> Project Specific Certification: Construction Phase Responsible Charge: Jose Sanchez Phone: 305-687-2611	
<input type="checkbox"/> Not Certified, Local Agency has attached a Certification Schedule *	
<input type="checkbox"/> Not Certified, Local Agency does not have a Certification Schedule*	

B. PROJECT INFORMATION

PROJECT TITLE: Section 12 Sidewalk Improvement
PROJECT LOCATION: From West 32nd Street to West 37th Street
ROADWAY NAME AND/OR NUMBER: From West 12th Avenue to West 8th Avenue
PURPOSE OF PROJECT: Sidewalk improvement
PROJECT BRIEF DESCRIPTION: Adding sidewalk where sidewalk is missing and ADA ramps improvements on all corners

Note: All questions on the application **must** have a response. Failure to respond **to all** questions will result in a **disqualification** of the application. Should you feel that a question is not applicable to your project, please respond "not applicable."

FOR FDOT USE ONLY		
Application Complete	<input type="checkbox"/> YES	<input type="checkbox"/> NO
Project Eligible	<input type="checkbox"/> YES	<input type="checkbox"/> NO

¹ All Agencies shall be certified according to the Local Agency Program Manual Chapter 2, for more details contact the Local Programs office at (305) 470-5141
https://fdotwww.blob.core.windows.net/sitefinity/docs/default-source/programmanagement/lap/manual/final-ch2-20190319.pdf?sfvrsn=a03958a9_2

C. TA QUALIFYING ACTIVITIES - PROJECT CRITERIA

Select the Transportation Alternative activity that the proposed project will address. Please select one activity that represents most of the work proposed. Eligible activities must be consistent with details described under 23 U.S.C. 101(a) (29) and 213(b). (Note: selecting more than one activity does not ensure or increase eligibility.)

1. ☒ Construction of on-road and off-road trail facilities for pedestrians, bicyclists, and other non-motorized forms of transportation, including sidewalks, bicycle infrastructure, pedestrian and bicycle signals, traffic calming techniques, lighting and other safety - related infrastructure, and transportation projects to achieve compliance with the Americans with Disabilities Act of 1990
2. ☒ Construction, planning, and design of infrastructure-related projects and systems that will provide safe routes or for non-drivers, including children, older adults, and individuals with disabilities to access daily needs
3. ☐ Conversion and use of abandoned railroad corridors for trails for pedestrians, bicyclists, or other non-motorized Transportation users
4. ☐ Construction of turnouts, overlooks, and viewing areas
5. ☐ Community improvement activities, which include but are not limited to:
 - a) ☐ Inventory, control, or removal of outdoor advertising
 - b) ☐ Historic preservation and rehabilitation of historic transportation facilities
 - c) ☐ Vegetation management practices in transportation rights-of-way to improve roadway safety, prevent against invasive species, and provide erosion control
 - d) ☐ Archaeological activities relating to impacts from implementation of a transportation project eligible under Title 23
6. ☐ Any environmental mitigation activity, including pollution prevention and pollution abatement activities and mitigation to:
 - a) ☐ Address storm water management, control, and water pollution prevention or abatement related to highway construction or due to highway runoff, including activities described in sections 133(b) (11), 328(a), and 329 of Title 23; or
 - b) ☐ Reduce vehicle-caused wildlife mortality or restore and maintain connectivity among terrestrial or aquatic habitats
7. ☐ SRTS program-eligible projects and activities listed in section 1404(f) of the SAFETEA-LU:
 - a) ☐ Infrastructure-related projects
 - b) ☐ Non-infrastructure-related projects
 - c) ☐ Safe Routes to School Coordinator
8. ☐ Planning, designing, and constructing boulevards² and other roadways largely in the Right-of-Way of former Interstate System routes or other divided highways
9. ☐ Recreational trails program³

² A boulevard is defined as a walkable, low speed (35 mph or less) divided arterial thoroughfare in urban environments designed to carry both through and local traffic, pedestrians and bicyclists. Boulevards may be long corridors, typically four lanes but sometimes wider, serve longer trips, provide pedestrian access to land, may be high ridership transit corridors, are primary emergency response routes and use vehicular and pedestrian access management techniques. Curb parking is encouraged.

³ https://www.fhwa.dot.gov/environment/transportation_alternatives/guidance/guidance_2016.cfm#RecreationalTrails

D. PROJECT DETAILS

1. Roadway Classification:

☐ State Roadway ☐ Federal Aid Roadway ☒ Local Roadway ☐ Other

2. Project Termini:

Begin: West 32th Street **End:** West 37th Street **Project Length:** 1500 LF

If the project has various locations, include an attachment specifying each termini and project length.

Attachment included? ☒ Yes ☐ No

3. Location maps and aeriels are attached: REQUIRED

☒ Yes ☐ No

4. Provide the Scope of Work: See Concept Plans

A detailed scope of work is attached ☒ Yes ☐ No

Conceptual plans are attached ☒ Yes ☐ No

Typical section drawings are attached ☒ Yes ☐ No

5. Identify the project stakeholders: [Click here to enter text.](#)

Has the Local Agency received input from stakeholders? ☐ Yes ☒ No

Briefly explain [Click here to enter text.](#)

6. Has the Local Agency performed public awareness activities or held community meetings?

☐ Yes ☒ No

If yes, provide a brief description and attach supporting documentation: [Click here to enter text.](#)

7. Is there public and/or private support for the project?

☐ Yes ☒ No

If yes, provide a brief description and attach supporting documentation (e.g. petitions, written endorsements, resolutions, letters of support, etc.): [Click here to enter text.](#)

E. PROJECT IMPLEMENTATION PLAN

1. Select the project phase(s) the local agency is applying for in this application:

☐ Planning Activities ☐ Project Development & Environment⁴
☒ Preliminary Engineering/Final Design ☐ Right of Way⁵
☒ Construction ☒ Construction Engineering & Inspection (CEI)

NOTE: Local agencies are not eligible to be certified in PD&E and/or ROW; therefore, funds cannot be requested to self-administer PD&E and/or ROW phase (s).

2. Select who will execute the project phase (s) identified in the question above. Check all applicable boxes:

PLANNING	PD&E	DESIGN	ROW	CONSTRUCTION	CEI
<input type="checkbox"/> Local Agency Staff	<input type="checkbox"/> FDOT	<input type="checkbox"/> Local Agency Staff	<input type="checkbox"/> FDOT	<input checked="" type="checkbox"/> Contractor	<input type="checkbox"/> Local Agency Staff ⁶
<input type="checkbox"/> Consultant	<input checked="" type="checkbox"/> Not Applicable	<input checked="" type="checkbox"/> Consultant	<input checked="" type="checkbox"/> Not Applicable	<input type="checkbox"/> FDOT	<input checked="" type="checkbox"/> Consultant
<input checked="" type="checkbox"/> Not Applicable		<input type="checkbox"/> FDOT		<input type="checkbox"/> Not Applicable	<input type="checkbox"/> FDOT
		<input type="checkbox"/> Not Applicable			<input type="checkbox"/> Not Applicable

Note: Chapter 337.14 Florida Statutes was amended by HB 905, effective July 1, 2019 prohibiting an entity from performing both design services and construction engineering and inspection services for a project wholly or partially funded by the Department of Transportation and administered by a local governmental entity.

⁴ Refer to LAP Manual Chapter 11

⁵ Refer to LAP Manual Chapter 12

⁶ Work done by local agency staff requires prior FDOT approval in any phase identified

3. Is this project related to other FDOT funded phase(s) that are complete, underway or in FDOT's 5-year Work Program? ☐ Yes ☒ No

If yes, provide the associated 11-digit Financial Management number(s): [Click here to enter text.](#)

4. Are signed and sealed design plans available for the project associated with this application? ☐ Yes ☒ No

a. If yes, are design plans updated to current standards and existing conditions? ☐ Yes ☒ No

1. Specify the date of design plans developed? [Click here to enter text.](#)

2. Enter Engineer of Record contact information: [Click here to enter text.](#)

b. If no, identify status of design plans

☒ No plans

☐ 30%

☐ 60%

☐ 90%

☐ Other Describe: [Click here to enter text.](#)

5. Attach a project schedule (dates may be tentative) SEE EXHIBITS A THRU F

Include (as applicable):

Consultant acquisition & award ☒ Yes ☐ No

Contractor acquisition & award ☒ Yes ☐ No

Project schedule and production dates ☐ Yes ☐ No

Plans preparation & review submittal (FDOT 30 days review) ☐ Yes ☐ No

Environmental Assessments ☐ Yes ☐ No

Permit Acquisition ☐ Yes ☐ No

6. Identify permits required: DERM

Copies of permits are attached to this application ☐ Yes ☒ No

7. Is a maintenance plan proposed? ☐ Yes ☒ No

Describe: [Click here to enter text.](#)

8. Attach documents requested as exhibits to this application. List exhibits: [Click here to enter text.](#)

F. RIGHT OF WAY

1. Is the project within the Local Agency's right of way? ☒ Yes ☐ No

If yes, describe the project's existing Right-of-Way ownership as it relates to the project. (i.e. plats, deeds, prescriptions, certified surveys, easements). See Existing Plats

If no, describe the existing ROW conditions. [Click here to enter text.](#)

2. Is Right-of-Way acquisition proposed in this application? ☐ Yes ☒ No

If yes, describe the proposed acquisition and provide a ROW map [Click here to enter text.](#)

Identify entity acquiring and retaining ownership of proposed Right-of-Way⁷: [Click here to enter text.](#)

Will temporary construction easements be required? ☐ Yes ☐ No

If yes, please describe: [Click here to enter text.](#)

⁷ All right-of-way acquisitions must comply with State and Federal rules, regulations and procedures.

G. ENVIRONMENTAL EVALUATION

Coordination with the Federal Highway Administration and the State Historic Preservation Officer will be required by Section 106 of the National Historic Preservation Act.

A. Has the Local Agency performed an environmental assessment for the project? ☐ Yes ☒ No

List the environmental assessments performed: [Click here to enter text.](#)

B. Does the Local Agency have a historic preservation planner? ☐ Yes ☒ No

If yes, provide contact information: [Click here to enter text.](#)

C. Is the proposed project located adjacent to a locally designated historic property or a National Register of Historic places-listed historic site? ☐ Yes ☒ No

If yes, have any historic properties/places received Florida Department of State Historic Preservation Grant funds?

☐ Yes ☒ No

If yes, attach preservation agreements, covenants, or easements.

D. Are archeological sites or Native American sensitive sites located within proximity to or adjacent to the project? ☐ Yes ☒ No

If yes, provide a brief description: [Click here to enter text.](#)

E. Has the Local Agency coordinated with any Federal or State Agencies for this project? ☐ Yes ☒ No

If yes, provide a brief description and submit supporting documentation: [Click here to enter text.](#)

F. Are parks, recreation areas or wildlife or waterfowl refuges in close proximity to the project? ☐ Yes ☒ No

If yes, provide a brief description: [Click here to enter text.](#)

G. Are there any navigable waterways adjacent or near the project? ☐ Yes ☒ No

If yes, provide a brief description: [Click here to enter text.](#)

H. Does the project have any wetland impacts? ☐ Yes ☒ No

If yes, will wetlands mitigation be needed?

☐ Yes ☐ No

If yes, provide a brief description: [Click here to enter text.](#)

I. Has the Local Agency reviewed the project for potential protected species/ critical habitat impacts? ☐ Yes ☒ No

If yes, provide a brief description: [Click here to enter text.](#)

J. Has the Local Agency reviewed the project for potential contamination that could affect the area? ☐ Yes ☒ No

If yes, provide a brief description: [Click here to enter text.](#)

K. Are there noise sensitive areas? ☐ Yes ☒ No

If yes, provide a brief description: [Click here to enter text.](#)

H. COST ESTIMATE

- For projects that have not been designed, an opinion of probable cost **must be** submitted with this application. Utilize the FDOT's Basis of Estimates Manual⁸ to develop a **detailed** estimate with FDOT pay items for construction phase estimates. **If the project has been designed, then, a detailed engineer cost estimate must be submitted with this application.**

The opinion of probable cost or engineers cost estimate is attached to this application

☒ Yes ☐ No

2. Provide a summary of the estimated costs for the proposed work in the table below

A project cost estimate **must** be attached to this application

Activities	Total Cost	Local Funds	TA Funds
Planning Activities	\$0.0	\$0.0	\$0.0
Project Development & Environmental Study	\$0.0	\$0.0	\$0.0
Design Costs/ Plans Preparation	\$25,208.00	\$25,208.00	\$0.00
Environmental Assessment(s) associated with the design phase	\$ 0.00	\$ 0.00	\$0.00
Permits associated with the design phase (including application fees, mitigation, and permit acquisition work)	\$0.00	\$0.00	\$0.00
Right of Way	\$0.0	\$0.0	\$0.0
Construction	\$252,085.00	\$0.00	\$252,085.00
Construction Engineering and Inspection activities (CEI)	\$25,208.00	\$25,208.00	\$0.00
Other Costs (describe) ⁹ <i>Click here to enter text.</i>	\$0.0	\$0.0	\$0.0
Total Estimated Project Cost	\$302,501.00	\$50,416.00	\$252,085.00

I. PROJECT FUNDING

TA FUNDS	\$ 252,085.00	PERCENTAGE OF TA FUNDS	83%
LOCAL FUNDS ALLOCATED	\$ 50,416.00	PERCENTAGE OF LOCAL CONTRIBUTION	17 %
TOTAL PROJECT COST	\$ 302,501.00		

Note: The percentage of local contribution indicated above will be greater than or equal to the local contribution to the final contract award.

Example A: A 20% local contribution is indicated for a construction project. The local agency was awarded \$1,000,000. The bid amount is \$1,000,000. The awarded amount would be reduced to \$800,000. The local agency would contribute \$200,000.

⁸ Use the following links to access the Basis of Estimates Manual as well as historical cost information for your area:

<http://www.fdot.gov/programmanagement/Estimates/BasisofEstimates/BOEManual/BOEOnline.shtm>

<http://www.fdot.gov/programmanagement/Estimates/HistoricalCostInformation/HistoricalCost.shtm>

⁹ FDOT does not allow programming for contingency costs. Any contingency costs should be accounted for using local funds.

Example B: A 20% local contribution is indicated for a construction project. The local agency was awarded \$1,000,000. The bid amount is \$1,400,000. The awarded amount would remain \$1,000,000. The local agency would contribute \$400,000.

1. Describe in detail how the project will be funded (include funding types and commitment of funds):

Local Option Gas Tax (LOGT)

2. Provide the funding year for each phase(s) of the project:

Fiscal Year 2022

3. Provide a letter from the Local Agency's Budget Office committing Local Funds to the project.

A copy of the letter is included with this application.

☐ Yes ☒ No

J. Project Sponsorship Certification

I hereby certify that the proposed project herein described is supported by City of Hialeah (Local Agency, county, state or federal agency, or tribal council) and that said entity will: (1) provide any required funding match; (2) enter into a maintenance agreement with the Florida Department of Transportation (FDOT); (3) comply with the Federal Uniform Relocation Assistance and Acquisition Policies Act for any Right of Way actions required for the project, (4) Comply with Local Agency Program Manual during all phases of the project, (5) comply with the NEPA process prior to construction, which may involve coordination with the State Historic and Preservation Office (SHPO) prior to construction, and (6) support other actions necessary to fully implement the proposed project.

I further certify that the estimated costs are reasonable and understand that City of Hialeah (Local Agency, county, state or federal agency, or tribal council) will bear all expenses in excess of the total cost of the project. Upon notification of project award, I further certify that the aforementioned entity will work with the FDOT to ensure the associated contracts are executed in the fiscal year programmed. Project deferrals are highly discouraged and are subject to fund availability.

Name (please type or print): Jose Sanchez

Title: Street Director

Signature:  _____

Date: 02/19/21

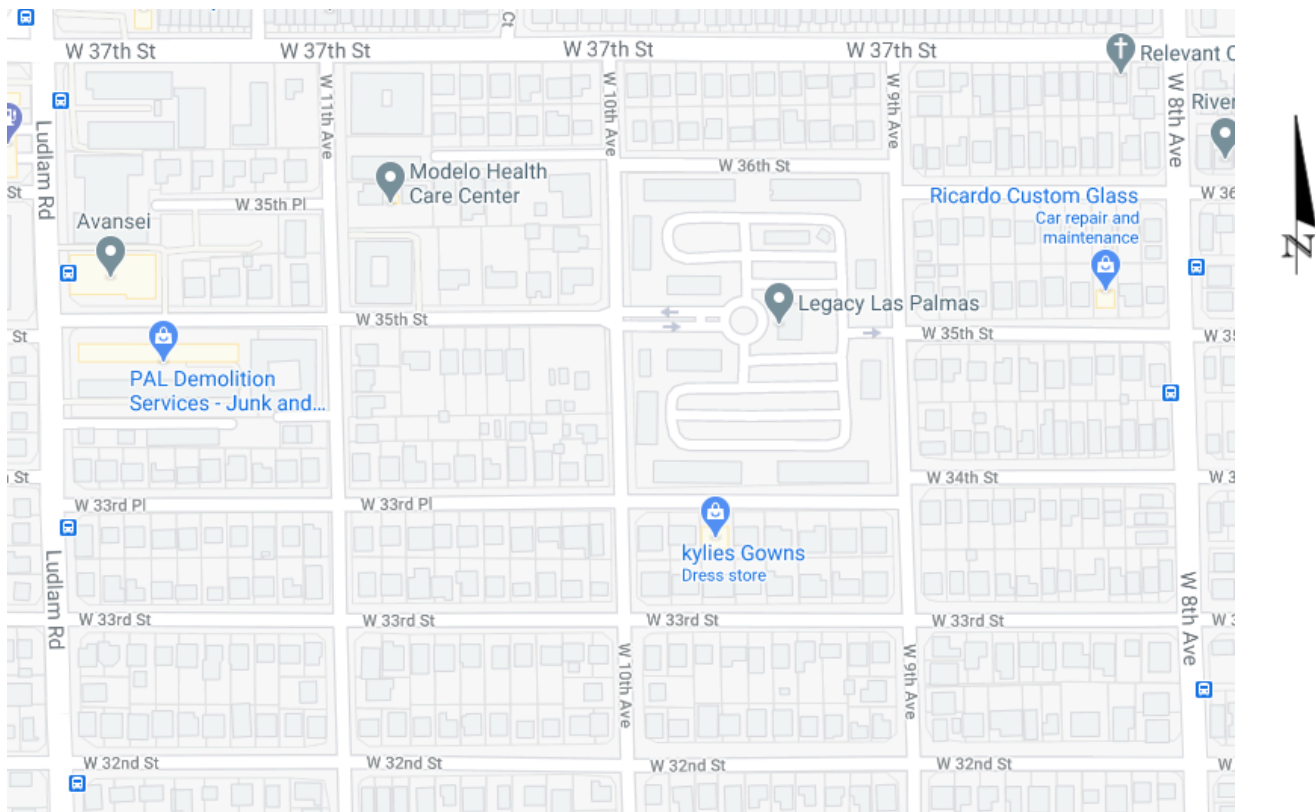

LOCATION MAP

EXHIBIT A: CONCEPT PLAN

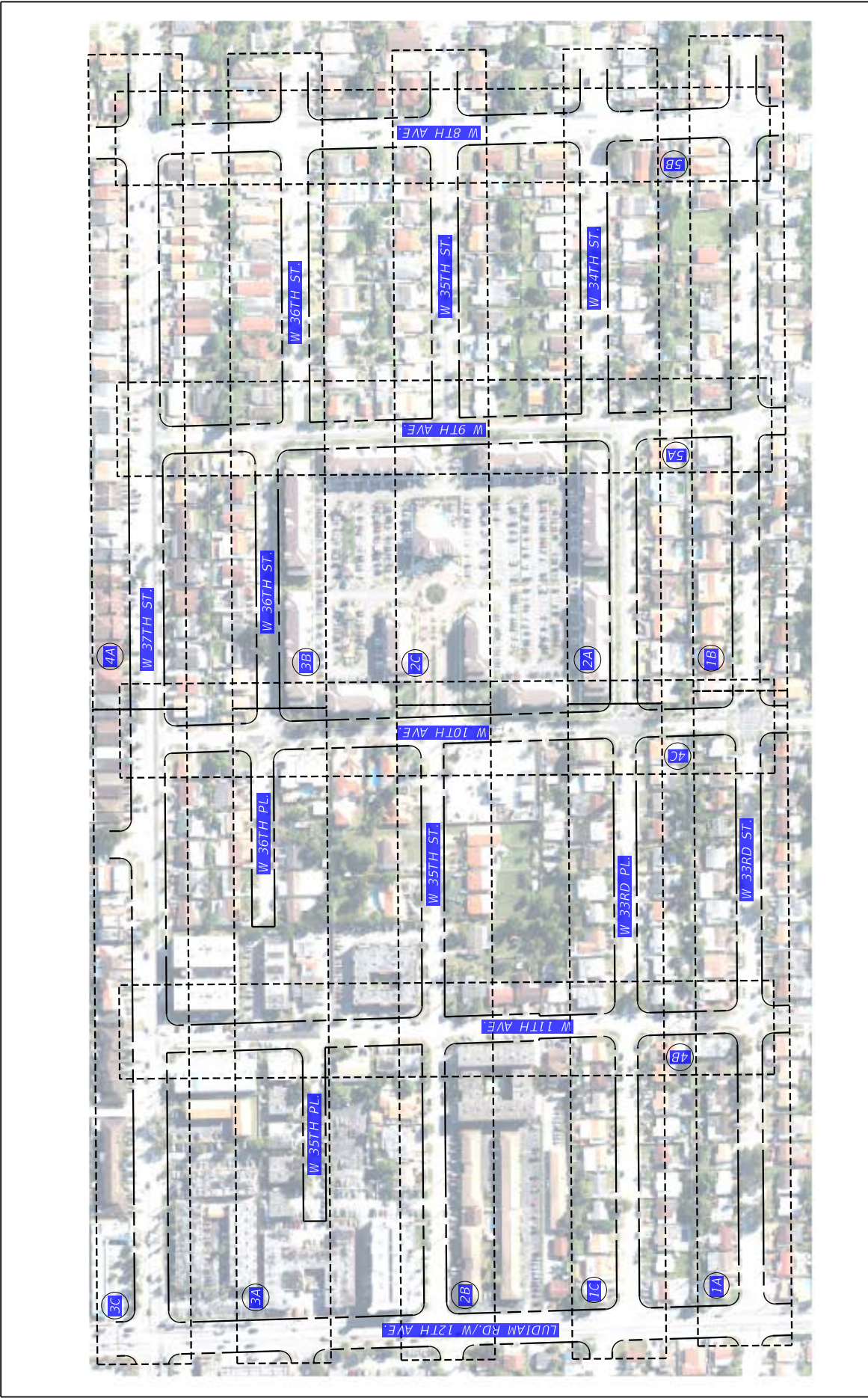

REVISIONS		CITY OF HIALEAH		PROJECT LAYOUT		SHEET NO.
DATE	DESCRIPTION	DATE	DESCRIPTION			
						2

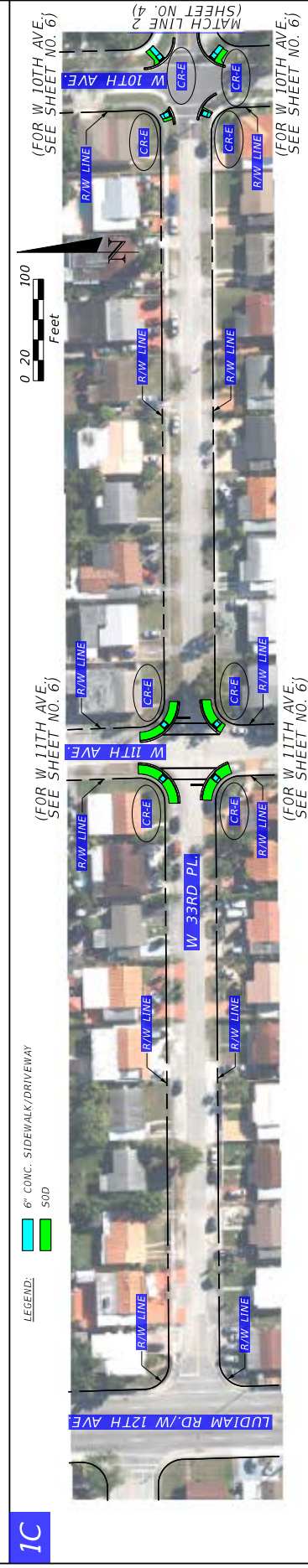
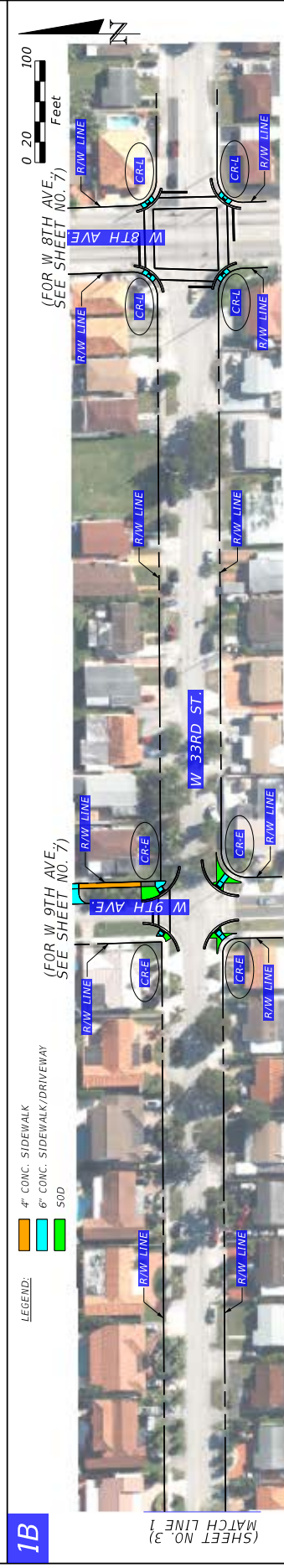
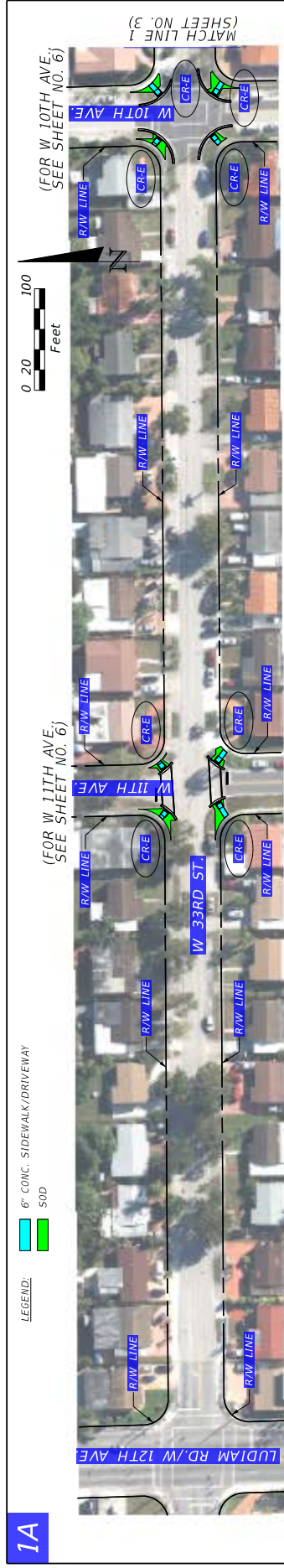

						<div style="text-align: center;"> CITY OF HIALEAH </div>	<div style="text-align: center;"> CONCEPT PLANS </div>	<div style="text-align: center;"> SHEET NO. 3 </div>

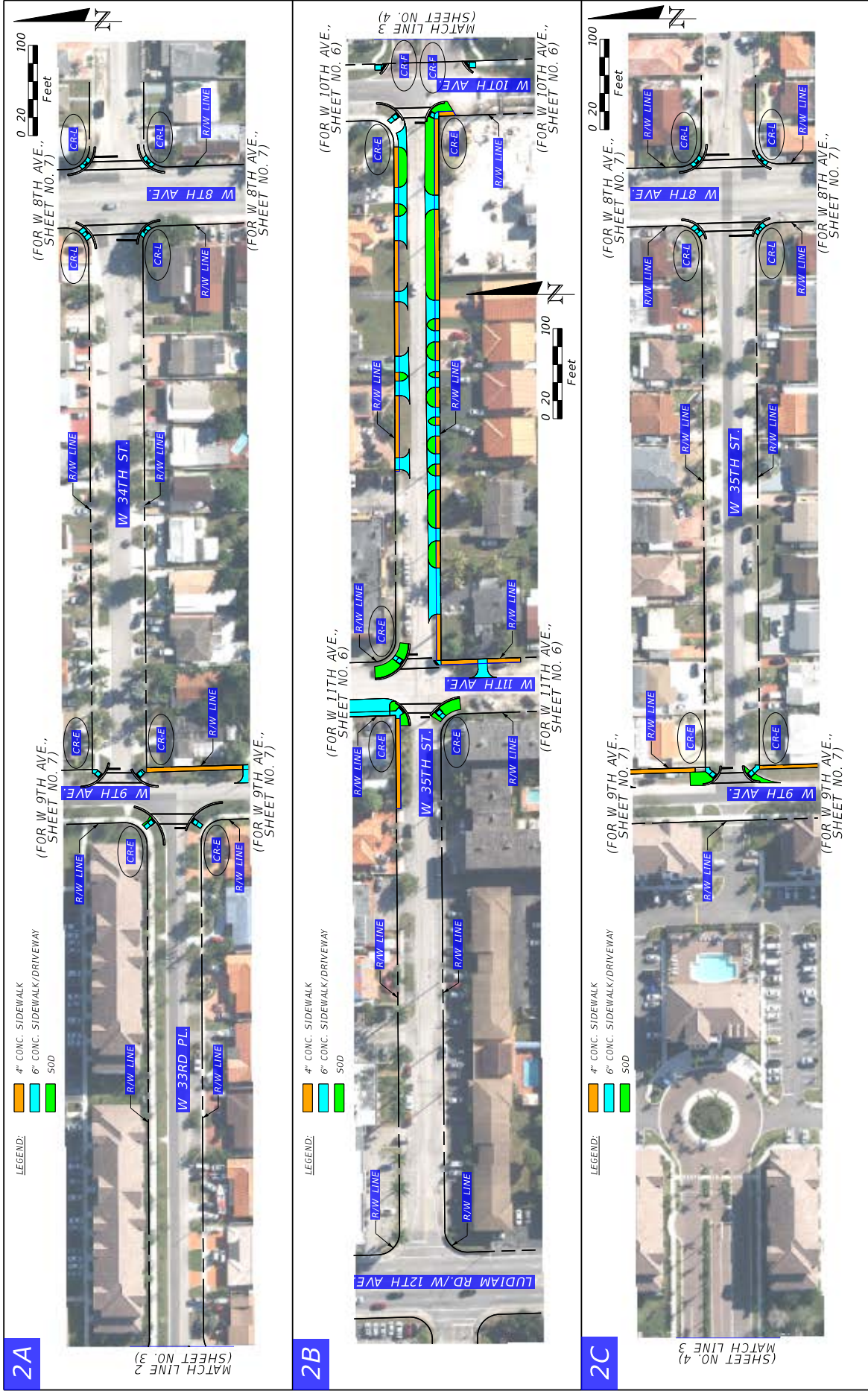

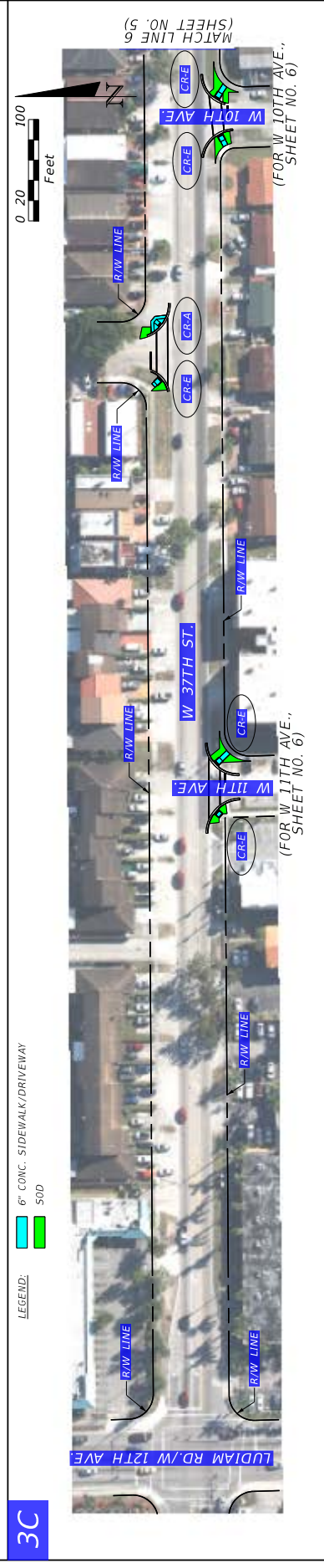
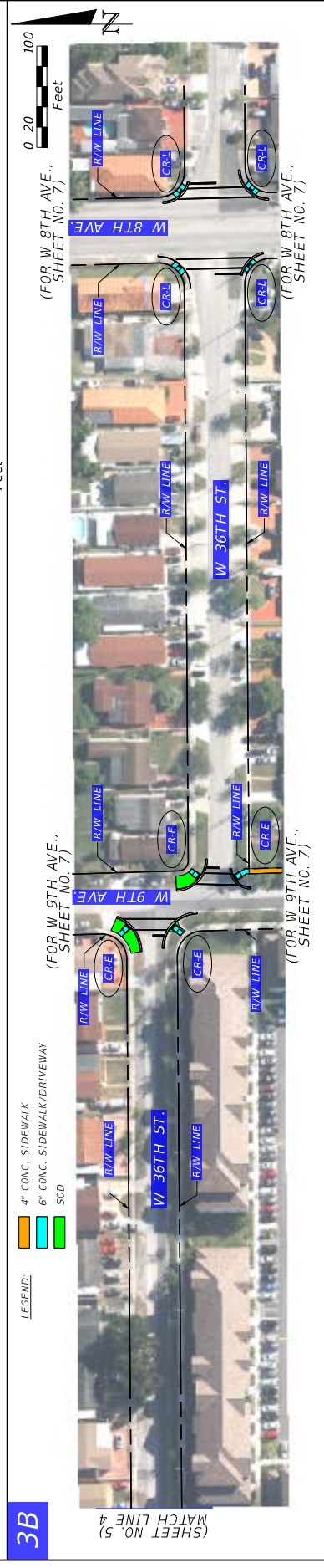
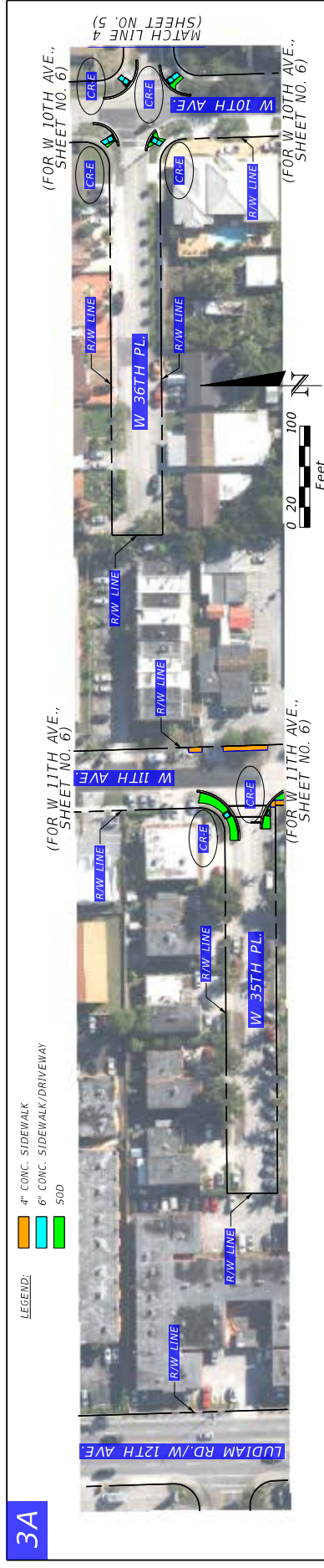

DATE	DESCRIPTION	REVISIONS		CITY OF HIALEAH	CONCEPT PLANS		SHEET NO.
		DATE	DESCRIPTION				
							4

[illegible]

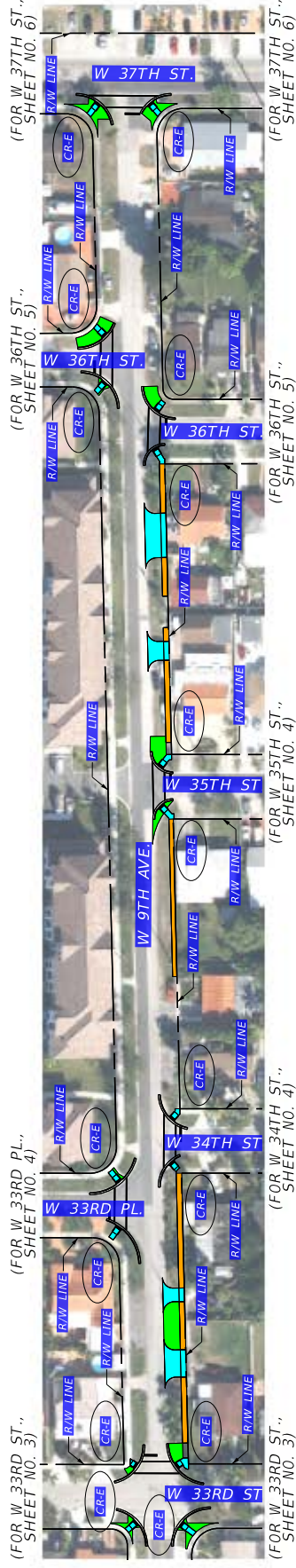
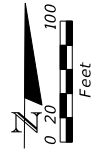



LEGEND:

	4" CONC. SIDEWALK
	6" CONC. SIDEWALK/DRIVEWAY
	SOD

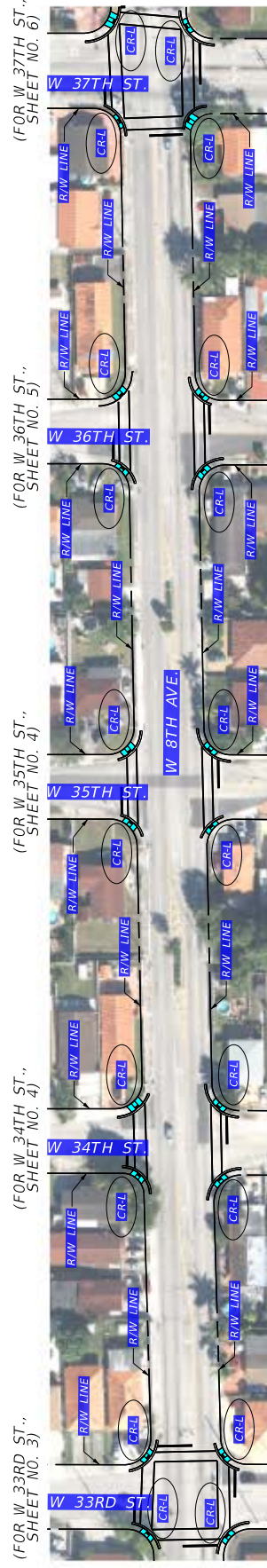

LEGEND: 6" CONC. SIDEWALK/DRIVEWAY

--	--	--	--	--	--	--	--	--	--	--	--	--	--	--	--	--	--	--	--	--	--	--	--	--	--	--	--	--	--	--	--	--	--	--	--	--	--	--	--	--	--	--	--	--	--	--	--	--	--	--	--	--	--	--	--	--	--	--	--	--	--	--	--	--	--	--	--	--	--	--	--	--	--	--	--	--	--	--	--	--	--	--	--	--	--	--	--	--	--	--	--	--	--	--	--	--	--	--	--	--	--	--	--	--	--	--	--	--	--	--	--	--	--	--	--	--	--	--	--	--	--	--	--	--	--	--	--	--	--	--	--	--	--	--	--	--	--	--	--	--	--	--	--	--	--	--	--	--	--	--	--	--	--	--	--	--	--	--	--	--	--	--	--	--	--	--	--	--	--	--	--	--	--	--	--	--	--	--	--	--	--	--	--	--	--	--	--	--	--	--	--	--	--	--	--	--	--	--	--	--	--	--	--	--	--	--	--	--	--	--	--	--	--	--	--	--	--	--	--	--	--	--	--	--	--	--	--	--	--	--	--	--	--	--	--	--	--	--	--	--	--	--	--	--	--	--	--	--	--	--	--	--	--	--	--	--	--	--	--	--	--	--	--	--	--	--	--	--	--	--	--	--	--	--	--	--	--	--	--	--	--	--	--	--	--	--	--	--	--	--	--	--	--	--	--	--	--	--	--	--	--	--	--	--	--	--	--	--	--	--	--	--	--	--	--	--	--	--	--	--	--	--	--	--	--	--	--	--	--	--	--	--	--	--	--	--	--	--	--	--	--	--	--	--	--	--	--	--	--	--	--	--	--	--	--	--	--	--	--	--	--	--	--	--	--	--	--	--	--	--	--	--	--	--	--	--	--	--	--	--	--	--	--	--	--	--	--	--	--	--	--	--	--	--	--	--	--	--	--	--	--	--	--	--	--	--	--	--	--	--	--	--	--	--	--	--	--	--	--	--	--	--	--	--	--	--	--	--	--	--	--	--	--	--	--	--	--	--	--	--	--	--	--	--	--	--	--	--	--	--	--	--	--	--	--	--	--	--	--	--	--	--	--	--	--	--	--	--	--	--	--	--	--	--	--	--	--	--	--	--	--	--	--	--	--	--	--	--	--	--	--	--	--	--	--	--	--	--	--	--	--	--	--	--	--	--	--	--	--	--	--	--	--	--	--	--	--	--	--	--	--	--	--	--	--	--	--	--	--	--	--	--	--	--	--	--	--	--	--	--	--	--	--	--	--	--	--	--	--	--	--	--	--	--	--	--	--	--	--	--	--	--	--	--	--	--	--	--	--	--	--	--	--	--	--	--	--	--	--	--	--	--	--	--	--	--	--	--	--	--	--	--	--	--	--	--	--	--	--	--	--	--	--	--	--	--	--	--	--	--	--	--	--	--	--	--	--	--	--	--	--	--	--	--	--	--	--	--	--	--	--	--	--	--	--	--	--	--	--	--	--	--	--	--	--	--	--	--	--	--	--	--	--	--	--	--	--	--	--	--	--	--	--	--	--	--	--	--	--	--	--	--	--	--	--	--	--	--	--	--	--	--	--	--	--	--	--	--	--	--	--	--	--	--	--	--	--	--	--	--	--	--	--	--	--	--	--	--	--	--	--	--	--	--	--	--	--	--	--	--	--	--	--	--	--	--	--	--	--	--	--	--	--	--	--	--	--	--	--	--	--	--	--	--	--	--	--	--	--	--	--	--	--	--	--	--	--	--	--	--	--	--	--	--	--	--	--	--	--	--	--	--	--	--	--	--	--	--	--	--	--	--	--	--	--	--	--	--	--	--	--	--	--	--	--	--	--	--	--	--	--	--	--	--	--	--	--	--	--	--	--	--	--	--	--	--	--	--	--	--	--	--	--	--	--	--	--	--	--	--	--	--	--	--	--	--	--	--	--	--	--	--	--	--	--	--	--	--	--	--	--	--	--	--	--	--	--	--	--	--	--	--	--	--	--	--	--	--	--	--	--	--	--	--	--	--	--	--	--	--	--	--	--	--	--	--	--	--	--	--	--	--	--	--	--	--	--	--	--	--	--	--	--	--	--	--	--	--	--	--	--	--	--	--	--	--	--	--	--	--	--	--	--	--	--	--	--	--	--	--	--	--	--	--	--	--	--	--	--	--	--	--	--	--	--	--	--	--	--	--	--	--	--	--	--	--	--	--	--	--	--	--	--	--	--	--	--	--	--	--	--	--	--	--	--	--	--	--	--	--	--	--	--	--	--	--	--	--	--	--	--	--	--	--	--	--	--	--	--	--	--	--	--	--	--	--	--	--	--	--	--	--	--	--	--	--	--	--	--	--	--	--	--	--	--	--	--	--	--	--	--	--	--	--	--	--	--	--	--	--	--	--	--	--	--	--	--	--	--	--	--	--	--	--	--	--	--	--	--	--	--	--	--	--	--	--	--	--	--	--	--	--	--	--	--	--	--	--	--	--	--	--	--	--	--	--	--	--	--	--	--	--	--	--	--	--	--	--	--	--	--	--	--	--	--	--	--	--	--	--	--	--	--	--	--	--	--	--	--	--	--	--	--	--	--	--	--	--	--	--	--	--	--	--	--	--	--	--	--	--	--	--	--	--	--	--	--	--	--	--	--	--	--	--	--	--	--	--	--	--	--	--	--	--	--	--	--	--	--	--	--	--	--	--	--	--	--	--	--	--	--	--	--	--	--	--	--	--	--	--	--	--	--	--	--	--	--	--	--	--	--	--	--	--	--	--	--	--	--	--	--	--	--	--	--	--	--	--	--	--	--	--	--	--	--	--	--	--	--	--	--	--	--	--	--	--	--	--	--	--	--	--	--	--	--	--	--	--	--	--	--	--	--	--	--	--	--	--	--	--	--	--	--	--	--	--	--	--	--	--	--	--	--	--	--	--	--	--	--	--	--	--	--	--	--	--	--	--	--	--	--	--	--	--	--	--	--	--	--	--	--	--	--	--	--	--	--	--	--	--	--	--	--	--	--	--	--	--	--	--	--	--	--	--	--	--	--	--	--	--	--	--	--	--	--	--	--	--	--	--	--	--	--	--	--	--	--	--	--	--	--	--	--	--	--	--	--	--	--	--	--	--	--	--	--	--	--	--	--	--	--	--	--	--	--	--	--	--	--	--	--	--	--	--	--	--	--	--	--	--	--	--	--	--	--	--	--	--	--	--	--	--	--	--	--	--	--	--	--	--	--	--	--	--	--	--	--	--	--	--	--	--	--	--	--	--	--	--	--	--	--	--	--	--	--	--	--	--	--	--	--	--	--	--	--	--	--	--	--	--	--	--	--	--	--	--	--	--	--	--	--	--	--	--	--	--	--	--	--	--	--	--	--	--	--	--	--	--	--	--	--	--	--	--	--	--	--	--	--	--	--	--	--	--	--	--	--	--	--	--	--	--	--	--	--	--	--	--	--	--	--	--	--	--	--	--	--	--	--	--	--	--	--	--	--	--	--	--	--	--	--	--	--	--	--	--	--	--	--	--	--	--	--	--	--	--	--	--	--	--	--	--	--	--	--	--	--	--	--	--	--	--	--	--	--	--	--	--	--	--	--	--	--	--	--	--	--	--	--	--	--	--	--	--	--	--	--	--	--	--	--	--	--	--	--	--	--	--	--	--	--	--	--	--	--	--	--	--	--	--	--	--	--	--	--	--	--	--	--	--	--	--	--	--	--	--	--	--	--	--	--	--	--	--	--	--	--	--	--	--	--	--	--	--	--	--	--	--	--	--	--

EXHIBIT B: TYPICAL SECTION

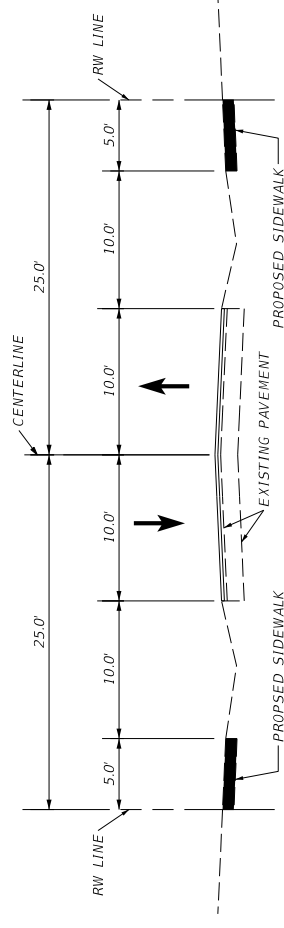

TYPICAL SECTION

--	--	--	--	--	--	--	--	--	--	--	--	--	--	--	--	--	--	--	--	--	--	--	--	--	--	--	--	--	--	--	--	--	--	--	--	--	--	--	--	--	--	--	--	--	--	--	--	--	--	--	--	--	--	--	--	--	--	--	--	--	--	--	--	--	--	--	--	--	--	--	--	--	--	--	--	--	--	--	--	--	--	--	--	--	--	--	--	--	--	--	--	--	--	--	--	--	--	--	--	--	--	--	--	--	--	--	--	--	--	--	--	--	--	--	--	--	--	--	--	--	--	--	--	--	--	--	--	--	--	--	--	--	--	--	--	--	--	--	--	--	--	--	--	--	--	--	--	--	--	--	--	--	--	--	--	--	--	--	--	--	--	--	--	--	--	--	--	--	--	--	--	--	--	--	--	--	--	--	--	--	--	--	--	--	--	--	--	--	--	--	--	--	--	--	--	--	--	--	--	--	--	--	--	--	--	--	--	--	--	--	--	--	--	--	--	--	--	--	--	--	--	--	--	--	--	--	--	--	--	--	--	--	--	--	--	--	--	--	--	--	--	--	--	--	--	--	--	--	--	--	--	--	--	--	--	--	--	--	--	--	--	--	--	--	--	--	--	--	--	--	--	--	--	--	--	--	--	--	--	--	--	--	--	--	--	--	--	--	--	--	--	--	--	--	--	--	--	--	--	--	--	--	--	--	--	--	--	--	--	--	--	--	--	--	--	--	--	--	--	--	--	--	--	--	--	--	--	--	--	--	--	--	--	--	--	--	--	--	--	--	--	--	--	--	--	--	--	--	--	--	--	--	--	--	--	--	--	--	--	--	--	--	--	--	--	--	--	--	--	--	--	--	--	--	--	--	--	--	--	--	--	--	--	--	--	--	--	--	--	--	--	--	--	--	--	--	--	--	--	--	--	--	--	--	--	--	--	--	--	--	--	--	--	--	--	--	--	--	--	--	--	--	--	--	--	--	--	--	--	--	--	--	--	--	--	--	--	--	--	--	--	--	--	--	--	--	--	--	--	--	--	--	--	--	--	--	--	--	--	--	--	--	--	--	--	--	--	--	--	--	--	--	--	--	--	--	--	--	--	--	--	--	--	--	--	--	--	--	--	--	--	--	--	--	--	--	--	--	--	--	--	--	--	--	--	--	--	--	--	--	--	--	--	--	--	--	--	--	--	--	--	--	--	--	--	--	--	--	--	--	--	--	--	--	--	--	--	--	--	--	--	--	--	--	--	--	--	--	--	--	--	--	--	--	--	--	--	--	--	--	--	--	--	--	--	--	--	--	--	--	--	--	--	--	--	--	--	--	--	--	--	--	--	--	--	--	--	--	--	--	--	--	--	--	--	--	--	--	--	--	--	--	--	--	--	--	--	--	--	--	--	--	--	--	--	--	--	--	--	--	--	--	--	--	--	--	--	--	--	--	--	--	--	--	--	--	--	--	--	--	--	--	--	--	--	--	--	--	--	--	--	--	--	--	--	--	--	--	--	--	--	--	--	--	--	--	--	--	--	--	--	--	--	--	--	--	--	--	--	--	--	--	--	--	--	--	--	--	--	--	--	--	--	--	--	--	--	--	--	--	--	--	--	--	--	--	--	--	--	--	--	--	--	--	--	--	--	--	--	--	--	--	--	--	--	--	--	--	--	--	--	--	--	--	--	--	--	--	--	--	--	--	--	--	--	--	--	--	--	--	--	--	--	--	--	--	--	--	--	--	--	--	--	--	--	--	--	--	--	--	--	--	--	--	--	--	--	--	--	--	--	--	--	--	--	--	--	--	--	--	--	--	--	--	--	--	--	--	--	--	--	--	--	--	--	--	--	--	--	--	--	--	--	--	--	--	--	--	--	--	--	--	--	--	--	--	--	--	--	--	--	--	--	--	--	--	--	--	--	--	--	--	--	--	--	--	--	--	--	--	--	--	--	--	--	--	--	--	--	--	--	--	--	--	--	--	--	--	--	--	--	--	--	--	--	--	--	--	--	--	--	--	--	--	--	--	--	--	--	--	--	--	--	--	--	--	--	--	--	--	--	--	--	--	--	--	--	--	--	--	--	--	--	--	--	--	--	--	--	--	--	--	--	--	--	--	--	--	--	--	--	--	--	--	--	--	--	--	--	--	--	--	--	--	--	--	--	--	--	--	--	--	--	--	--	--	--	--	--	--	--	--	--	--	--	--	--	--	--	--	--	--	--	--	--	--	--	--	--	--	--	--	--	--	--	--	--	--	--	--	--	--	--	--	--	--	--	--	--	--	--	--	--	--	--	--	--	--	--	--	--	--	--	--	--	--	--	--	--	--	--	--	--	--	--	--	--	--	--	--	--	--	--	--	--	--	--	--	--	--	--	--	--	--	--	--	--	--	--	--	--	--	--	--	--	--	--	--	--	--	--	--	--	--	--	--	--	--	--	--	--	--	--	--	--	--	--	--	--	--	--	--	--	--	--	--	--	--	--	--	--	--	--	--	--	--	--	--	--	--	--	--	--	--	--	--	--	--	--	--	--	--	--	--	--	--	--	--	--	--	--	--	--	--	--	--	--	--	--	--	--	--	--	--	--	--	--	--	--	--	--	--	--	--	--	--	--	--	--	--	--	--	--	--	--	--	--	--	--	--	--	--	--	--	--	--	--	--	--	--	--	--	--	--	--	--	--	--	--	--	--	--	--	--	--	--	--	--	--	--	--	--	--	--	--	--	--	--	--	--	--	--	--	--	--	--	--	--	--	--	--	--	--	--	--	--	--	--	--	--	--	--	--	--	--	--	--	--	--	--	--	--	--	--	--	--	--	--	--	--	--	--	--	--	--	--	--	--	--	--	--	--	--	--	--	--	--	--	--	--	--	--	--	--	--	--	--	--	--	--	--	--	--	--	--	--	--	--	--	--	--	--	--	--	--	--	--	--	--	--	--	--	--	--	--	--	--	--	--	--	--	--	--	--	--	--	--	--	--	--	--	--	--	--	--	--	--	--	--	--	--	--	--	--	--	--	--	--	--	--	--	--	--	--	--	--	--	--	--	--	--	--	--	--	--	--	--	--	--	--	--	--	--	--	--	--	--	--	--	--	--	--	--	--	--	--	--	--	--	--	--	--	--	--	--	--	--	--	--	--	--	--	--	--	--	--	--	--	--	--	--	--	--	--	--	--	--	--	--	--	--	--	--	--	--	--	--	--	--	--	--	--	--

EXHIBIT C: PROJECT SCHEDULE

EXHIBIT D: OPINION OF PROBABLE COST

ITEM	DESCRIPTION	UNIT	QTY	UNIT PRICE	TOTAL
101-1	MOBILIZATION (10% CONSTRUCTION COST)	LS	1	\$14,880.30	\$14,880.30
102-1	MAINTENANCE OF TRAFFIC (10% CONSTRUCTION COST)	LS	1	\$14,880.30	\$14,880.30
110-1-1	CLEARING AND GRUBBING, INCLUDES TREE REMOVAL (10% CONSTRUCTION COST)	LS	1	\$14,880.30	\$14,880.30
120-1	REGULAR EXCAVATION	CY	417	\$13.28	\$5,536.43
520-1-10	CONCRETE CURB & GUTTER, TYPE F	LF	3,036	\$17.49	\$53,104.89
522-1	CONCRETE SIDEWALK (4" THICK)	SY	848	\$34.44	\$29,205.12
522-2	CONCRETE SIDEWALK (6" THICK) INCLUDING PEDESTRIAN RAMPS	SY	1,653	\$53.05	\$87,712.87
527-2	DETECTABLE WARNINGS	SF	730	\$22.43	\$16,376.14
570-1-2	PERFORMANCE TURF (SOD)	SY	1,398	\$3.81	\$5,326.76
700-1-11	SIGN, SINGLE POST (LESS THAN 12 SF)	EA	10	\$299.94	\$2,999.40
711-11-123	TRAFFIC STRIPE SOLID (12' WHITE)	LF	3,203	\$1.59	\$5,092.45
711-11-125	TRAFFIC STRIPE SOLID (24' WHITE)	LF	622	\$3.36	\$2,090.26
CONSTRUCTION COST					\$252,085

EXHIBIT E: EXISTING RIGHT OF WAY MAPS

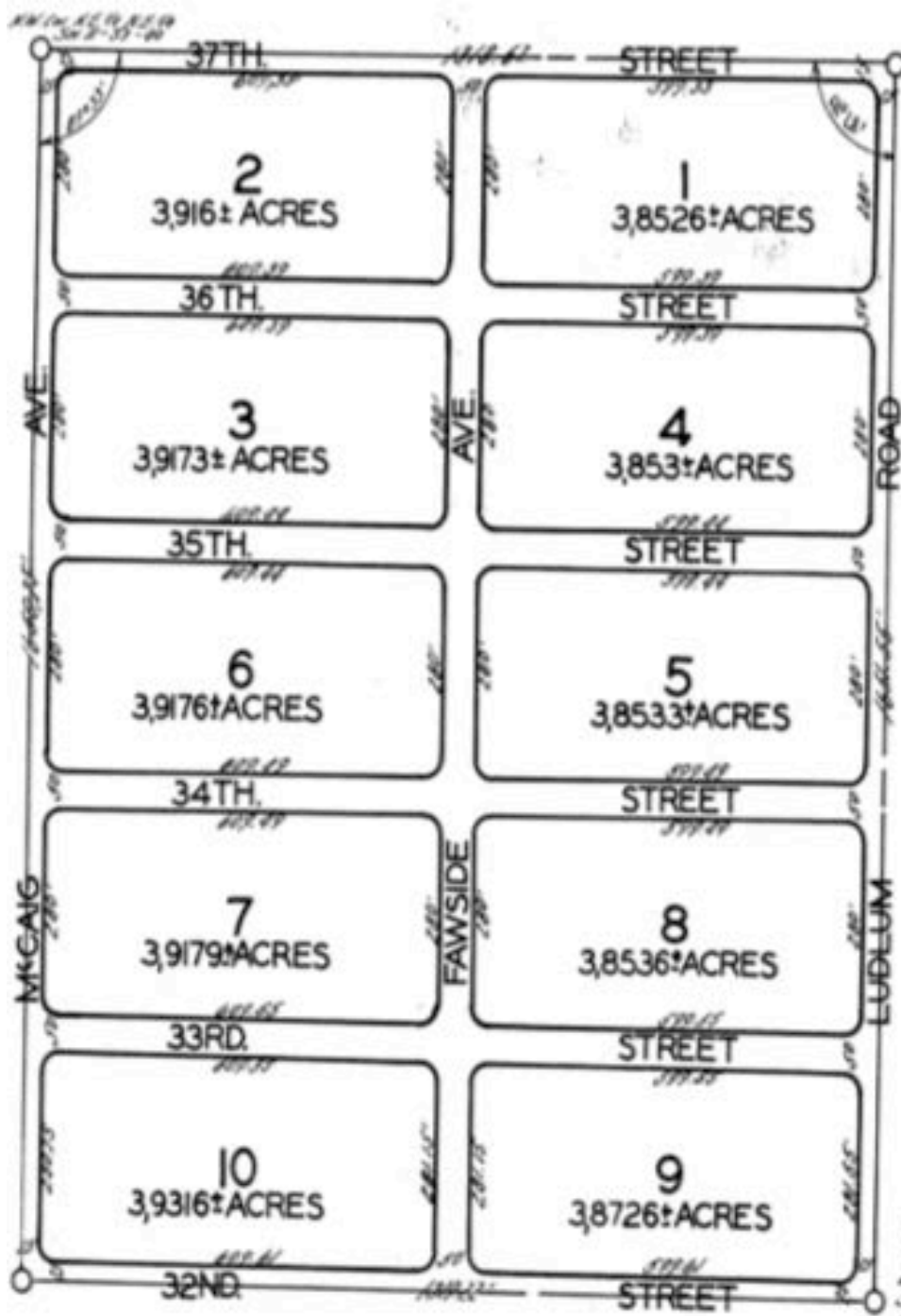

Engineers Note:-
 All lots are 25ft.
 Dimensions of tracts are 16.
 streetline intersections. The
 tracts crosshatched are not part
 of this plat.

EXHIBIT F: CITY OF HIALEAH LAP HISTORY

City of Hialeah LAP Projects History

Project No.	Location	Current Status
251630-3	I-75 & NW 138 St Interchange	Complete / Closed
407718-1	NW 138 St, 57 - 67 Ave	Complete / Closed / Pending Final Invoice
418349-1	Hialeah Linear Park	Complete / Closed
426193-1	E 4 Ave, 25 - 32 St	Complete / Closed
426194-1	W 29 St, Okeechobee Rd - W 4 Ave	Complete / Closed
426194-1 (Seq. 2)	W 29 St, Okeechobee Rd - W 4 Ave M/R	Complete / Closed
426195-1	Palm Ave, 45 - 47 St	Complete / Closed
426196-1	W 53 St, 4 - 8 Ave	Complete / Closed
426196-2	W 53 St, 8 - 12 Ave	Complete / Closed
426617-1	E 4 Ave, Hialeah Dr - E 21 St	Complete / Closed
427604-1	W 53 St, 12 - 16 Ave	Complete / Closed
427604-2	W 36 Ave, 76 - 84 St	Complete / Closed
427604-3	W 16 Ave, 76 - 84 St	Complete / Closed
427604-4	W 16 Ave, 68 - 78 St	Complete / Closed
427604-4	W 28 Ave, 52 - 80 St	Complete / Closed
436736-1	W 4 Ave Frontage Rd, 32 - 49 St	Approved for FY 2019-2020 Funding / Pending Construction